

## DS-2CC102P(N)(-A) Mini Box Camera

Discontinued

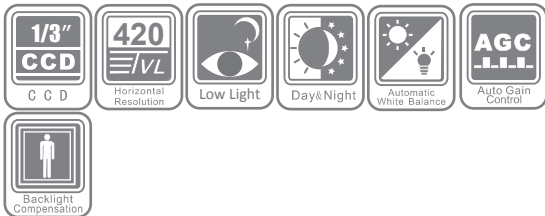

### Key Features

- 1/3" Sony CCD
- 420 TVL resolution
- Low illumination
- Compact design
- Day / night auto switch

### Specifications

| DS-2CC102P(N)(-A)     |  |
|-----------------------|--|
| <b>Camera</b>         |  |
| Image sensor          | 1/3" Sony CCD  |
| Signal system         | PAL / NTSC   |
| Effective pixels      | PAL: 500 (H) × 582 (V)<br>NTSC: 510 (H) × 492 (V)                    |
| Min. illumination     | 0.1 lux@F1.2, AGC on   |
| Shutter time          | PAL: 1/50s ~ 1/100,000s<br>NTSC: 1/60s ~ 1/100,000s                  |
| Lens mount            | C/CS mount   |
| Auto iris             | DC/Video drive   |
| Day & night           | Electronic   |
| Horizontal resolution | 420 TVL  |
| Synchronization       | Internal synchronization   |
| Video output          | 1Vp-p composite output(75 Ω / BNC)                                   |
| S/N ratio             | More than 48dB   |
| BLC                   | On / Off   |
| <b>General</b>        |  |
| Operating conditions  | -10°C ~ 60°C (14°F ~ 140°F)<br>Humidity 90% or less (non-condensing) |
| Power supply          | 12 VDC ± 10%<br>(-A series support 12 VDC ± 10%, 24 VAC ± 10%)       |
| Power consumption     | 2W max. (-A series 3.5W max.)  |
| Dimensions            | 63 × 67 × 125.3 mm (2.48" × 2.64" × 4.93")                           |
| Weight                | 550g (1.21 lbs)  |

### Available models

DS-2CC102P , DS-2CC102P-A, DS-2CC102N, DS-2CC102N-A

### Dimensions

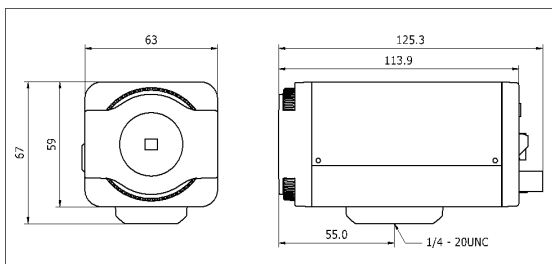

### Accessories

